

Project: Renovations of the
KOOPMANN RESIDENCE
33 PINE POINT ROAD
ROWAYTON, CT 06853

Owner:
**PAUL & KELLY
KOOPMANN**
33 PINE POINT ROAD
ROWAYTON, CT 06853
TEL: (203) 852-1554

NOTE:
ELEVATIONS SHOW DIMENSIONS FROM FINISH FACE OF
WALL UNLESS NOTED OTHERWISE. ALL PLANS SHOW
DIMENSIONS FROM FACE OF FRAMING.

PROJECT #:	03.018
CAD DWG FILE:	03018-3A-401.DWG
DRAWN BY:	GM
CHK'D BY:	MG
COPYRIGHT 2003, GREW DESIGN INC. MILTON GREGORY GREW, AIA, ARCHITECT - ALL RIGHTS RESERVED	
SHEET TITLE:	

**INTERIOR ELEVATIONS
KITCHEN AND
MASTER BATH**

A-401
SHEET 10 OF 12

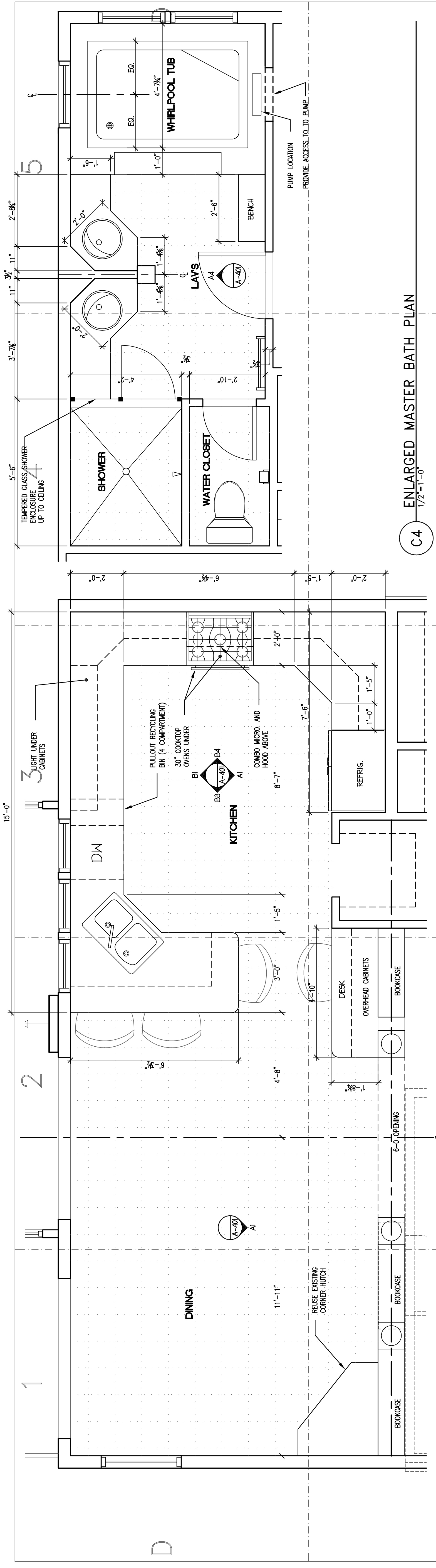

NOTE: DRAWINGS ARE FOR SCHEMATIC PURPOSES ONLY. NOSING, RADIUS, AND OTHER
DETAILS TO BE DETERMINED BY OWNER AND MANUFACTURER. ALL DIMENSIONS MUST BE
VERIFIED IN FIELD AFTER CONSTRUCTION AND INSTALLATIONS OF APPLIANCES AND
CABINETS.

